

## IST Extreme Duty Hitch Stabiliser Installation Guide

The iSi Extreme Duty hitch stabiliser is a special high strength device that replaces the standard tow-bar pin. This hitch stabiliser eliminates uncontrolled movement in yaw and roll inside the tow bar receiver tube but allows a small amount of vertical float for when travelling at speed over corrugations.

- 1 Orientate the nut pad flat face with the side that the screw will be inserted through, then insert the stabiliser pad inside the pivot base stinger tube. Line up with the desired tow bar pin hole.
- 2 Insert the pivot base into the tow bar receiver tube and align the desired hole with the tow bar pin hole.
- 3 Insert the stabiliser set screw with the split lock washer in and screw it all the way through – and **tighten the screw hard** – and then a bit more (200Nm-250Nm).
- 4 Finally, the Nyloc nut at the other end - just **nipped up - but not tight**. The nut simply braces the other side of the tow bar and minimises any deflections under sever loads. DO NOT INSTALL NUT IF SCREW IS NOT TIGHT (Step 2)

**The pivot base should now be tight inside the tow bar and with slight vertical float. If not tight, loosen nut and tighten screw hard (step 2). Check again after 10-20km.**

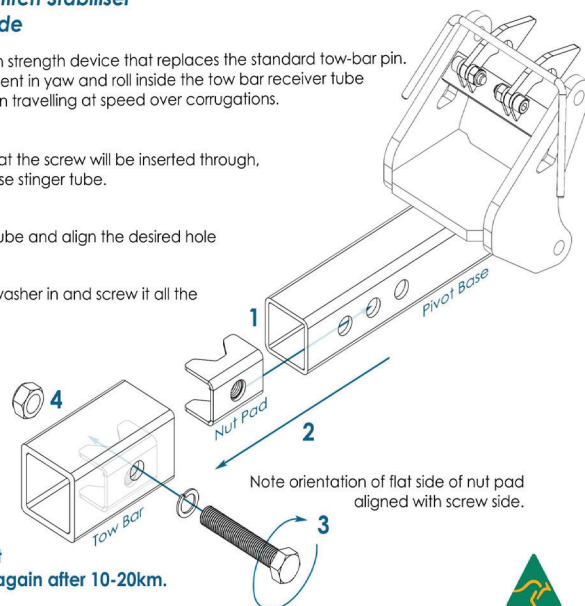

## IST EXTREME DUTY BICYCLE CARRIERS

### iSi 4x4x4 Bicycle Carrier System - Instructions

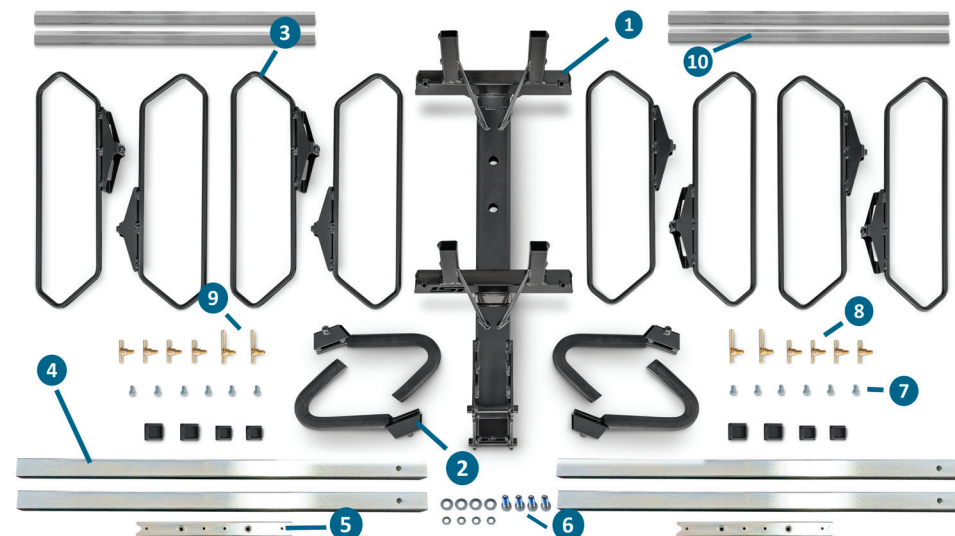

- |    |                                |        |
|----|--------------------------------|--------|
| 1  | Four Bicycle Carrier Main Beam | QTY: 1 |
| 2  | Frame Support Cradle           | QTY: 4 |
| 3  | Wheel Support Cradle           | QTY: 8 |
| 4  | Wheel Support Beam             | QTY: 4 |
| 5  | Tube Joiner                    | QTY: 2 |
| 6  | Tube Joiner Hardware:          |        |
|    | M8x25 Socket Head Cap Screw    | QTY: 4 |
|    | Split Washer                   | QTY: 4 |
|    | Washer                         | QTY: 4 |
| 7  | M8x12 Cap Screw                | QTY: 8 |
| 8  | Frame Support Post             | QTY: 4 |
| 9  | T Handle Screw Short           | QTY: 8 |
| 10 | T Handle Screw Long            | QTY: 4 |

**Tools - 6mm Allen Key**



## Horizontal Wheel Support Beam Installation

Tools: 6mm Allen Key Included

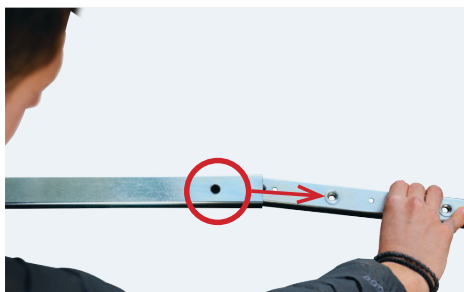

### Step 1

Insert one (half) wheel support beam onto both tube joiners, aligning holes.

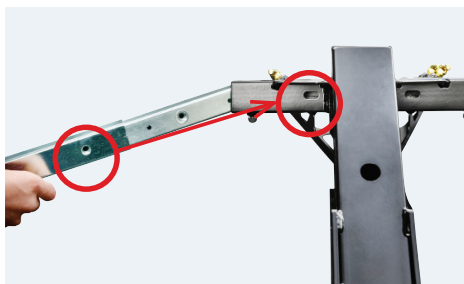

### Step 2

Flip Bicycle Carrier upside down to insert assembled wheel support beams into both wheel support tubes aligning holes.

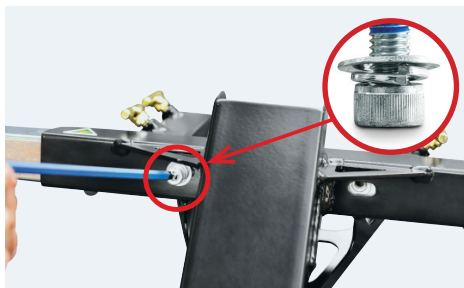

### Step 3

Assemble one spring washer, then one flat washer onto blue adhesive cap screw. Install the cap screw into the Bicycle Carrier but **do not tighten all the way**.

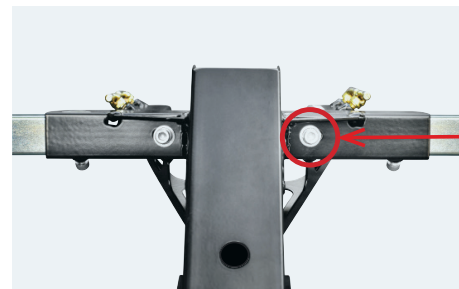

### Step 4

Insert second half of wheel support beam aligning tube joiner and main beam holes. Repeat **step 3**, tightening cap screw with spring and flat washer.



### Step 5

Mount the bicycle carrier main beam on either vehicle pivot base or draw bar mount and raise to travel position. Travel position requires both pins to be inserted.

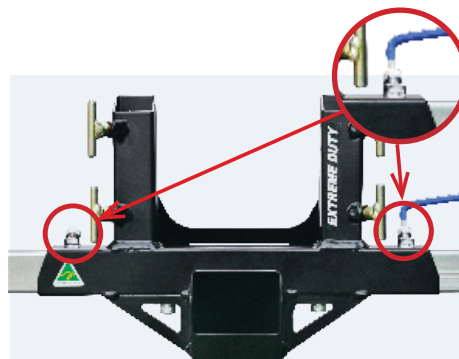

### Step 6

Tighten top two cap screws.

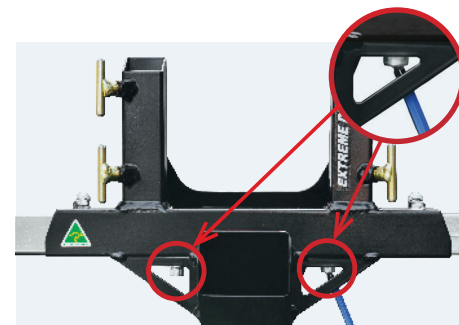

### Step 7

Finally, tighten the bottom two cap screws **\*tight\***, roughly 18nm.